



Plat of Survey

of
A portion of Burr Oak Drive
located in
Moraine Park Subdivision,
located in the Northeast 1/4 of Section 34, Town 4 North, Range 15 East, Town of Whitewater, Walworth County, Wisconsin.

Surveyed for: **Town of Whitewater**
W8590 Willis Ray Road
Whitewater, Wisconsin. 53190

Legal Description
A portion of Burr Oak Drive located in Moraine Park Subdivision, located in the Northeast 1/4 of Section 34, Town 4 North, Range 15 East, Town of Whitewater, Walworth County, Wisconsin, described as follows:
Commencing at an iron pipe at the Northeast corner of Lot 4 in Block 2 of said Moraine Park Subdivision; thence South 80°51'21" West, along the North line of said Lot 4, 22.00 feet to an iron pipe and the Point of Beginning; thence continue South 80°51'21" West, along said North line of Lot 4, 31.15 feet to an iron pipe; thence North 15°27'24" West 6.57 feet to an iron pipe; thence North 74°32'36" East 31.00 feet to an iron pipe; thence South 15°14'26" East 10.00 feet to the Point of Beginning.

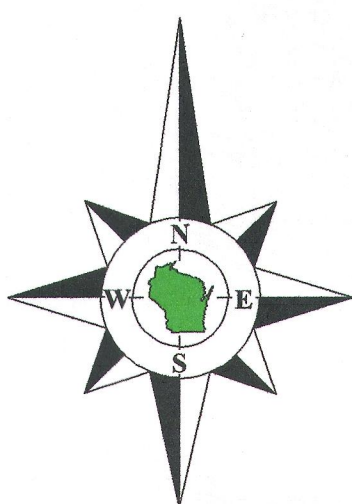

Bearings reference to the plat of Moraine Park Subdivision.

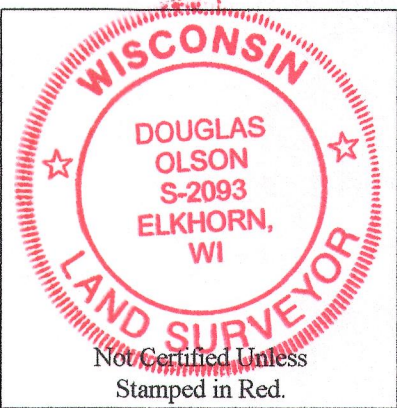

- Notes:**
- 1) This survey plat is not certified unless signed and sealed in red ink.
 - 2) This survey is subject to Wisconsin lien laws. This Plat of Survey is the notice of intent to file lien. Lien waiver required.

Copyright 2013 by Jensen & Olson Land Surveying, LLC.

All rights reserved. No part of this survey plat may be reproduced or transmitted in any form by any means - graphic, electronic, or mechanical, including photocopying, tracing, or information storage and retrieval systems - without permission in writing from Douglas G. Olson, Jensen & Olson Land Surveying, LLC.

I, Douglas G. Olson, Wisconsin Registered Land Surveyor, do hereby certify that this survey was performed by me, or under my direction in full compliance with the owner's/agent's instructions and Chapter A-E 7 of the Wisconsin Administrative Code "Minimum Standards for Property Surveys"; and that this map is an accurate representation thereof to the best of my knowledge and belief.

Douglas G. Olson
Wisconsin Registered Land Surveyor - 2093

Survey Date: May 7, 2014.
Revisions:

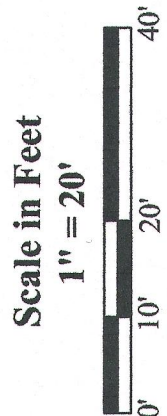

Jensen & Olson Land Surveying, LLC
45 South Wisconsin Street * P.O. Box 322 * Elkhorn, Wisconsin. 53121
Telephone: (262) 723-3434 * Facsimile: (262) 723-8044
Email: jensen.olson@elknet.net

- Legend**
- Ø Found Iron Pipe
 - () Recorded Information
 - Asphalt Surface
 - Concrete Surface
 - Gravel Surface

Sheet 1 of 1 Sheets
Drawing Name:
Job Reference Number
2013.140

2013.140

dmp-35
dmp-32 415-1349